

## CICERO - PLAN R3695A2S2ST-0DB

Total Area: 3695 sq. ft.  
Garage Area: 1465 sq. ft.  
Garage Area: 1465 sq. ft.  
Garage Size: 4  
Stories: 2  
Bedrooms: 4  
Full Baths: 2  
Half Baths: 1  
Width: 92'-6"  
Depth: 94'-6"  
Height: 18'-6"  
Foundation: Daylight Basement



## CICERO - PLAN R3695A2S2ST-0DB

### MAIN FLOOR



**CICERO - PLAN R3695A2S2ST-0DB**

**LOWER FLOOR**

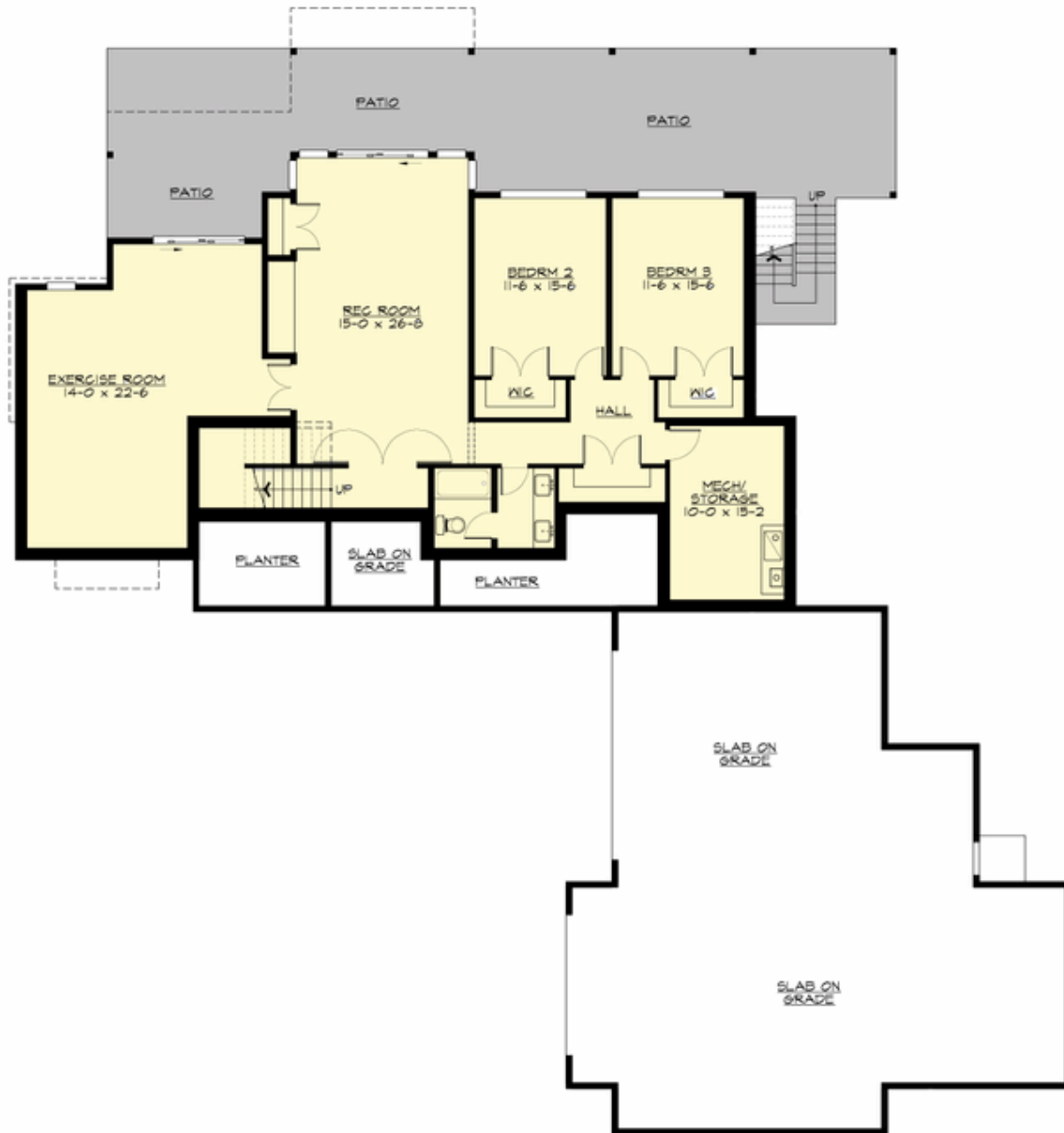

## **CICERO - PLAN R3695A2S2ST-0DB**

### **PLAN DETAILS**

#### **Area Summary**

Total Area: 3695 sq. ft.  
Main Floor: 1999 sq. ft.  
Lower Floor: 1696 sq. ft.  
Garage Floor: 1465 sq. ft.

#### **General Information**

Stories: 2  
Width: 92'-6"  
Depth: 94'-6"  
Height: 18'-6"

#### **Architectural Style**

Contemporary  
Modern  
Prairie

#### **Number of Rooms**

Bedrooms: 4  
Full Baths: 2  
Half Baths: 1

#### **Garage**

Garage Size: 4  
Garage Door Location: Side  
Garage Type: Tandem

#### **Roof Pitches**

Primary: 2:12

#### **Wall Heights**

Main: 10'-0"  
Lower: 10'-0"

#### **Foundation Type**

Daylight Basement

#### **Roof Framing**

Stick

#### **Floor Load**

Live (lbs): 40 PSF  
Dead (lbs): 10 PSF

#### **Roof Load**

Live (lbs): 25 PSF  
Dead (lbs): 15 PSF  
Wind: 85 MPH

#### **Design Features**

- Bonus Space @ Lower Floor
- Den/Office
- Great Room
- Laundry Room @ Main Floor
- Master Bedroom @ Main Floor Rear
- Rear Porch
- View Lot - Rear
- Wide Lot