

## MACLAREN PARK - PLAN M4446A3S-0

Total Area: 4446 sq. ft.  
Garage Area: 828 sq. ft.  
Garage Area: 828 sq. ft.  
Garage Size: 3  
Stories: 2  
Bedrooms: 4  
Full Baths: 3  
Half Baths: 1  
Width: 53'-0"  
Depth: 85'-0"  
Height: 25'-0"  
Foundation: Crawl Space



## MACLAREN PARK - PLAN M4446A3S-0

### MAIN FLOOR



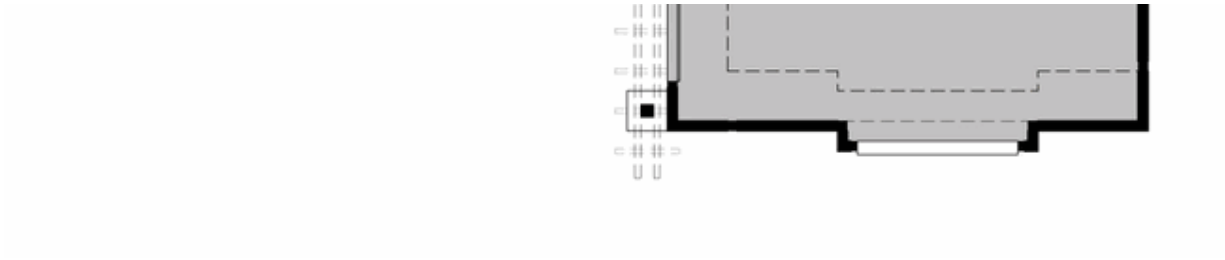

## MACLAREN PARK - PLAN M4446A3S-0

### UPPER FLOOR



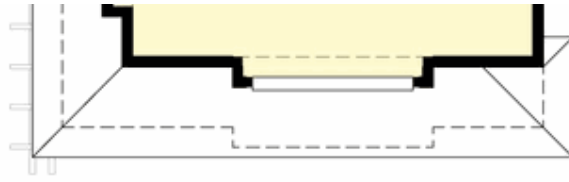

## MACLAREN PARK - PLAN M4446A3S-0

### PLAN DETAILS

#### Area Summary

Total Area: 4446 sq. ft.  
Main Floor: 2109 sq. ft.  
Upper Floor: 2337 sq. ft.  
Garage Floor: 828 sq. ft.

#### General Information

Stories: 2  
Width: 53'-0"  
Depth: 85'-0"  
Height: 25'-0"

#### Architectural Style

Craftsman  
Northwest  
Shingle

#### Number of Rooms

Bedrooms: 4  
Full Baths: 3  
Half Baths: 1

#### Garage

Garage Size: 3  
Garage Door Location: Side

#### Roof Pitches

Primary: 6:12  
Secondary: 4:12

#### Wall Heights

Main: 10'-0"  
Upper: 9'-0"

#### Foundation Type

Crawl Space

#### Roof Framing

Trusses

#### Floor Load

Live (lbs): 40 PSF  
Dead (lbs): 10 PSF

#### Roof Load

Live (lbs): 25 PSF  
Dead (lbs): 15 PSF  
Wind: 85 MPH

#### Design Features

- Bonus Space @ Upper Floor
- Den/Office
- Front and Rear Porch
- Great Room
- Laundry Room @ Upper Floor
- Master Bedroom @ Upper Floor Front
- Narrow Lot