

MALDEN RIDGE - PLAN M1852B2F-0

Total Area: 1852 sq. ft.
Garage Area: 418 sq. ft.
Garage Area: 418 sq. ft.
Garage Size: 2
Stories: 2
Bedrooms: 4
Full Baths: 2
Half Baths: 1
Width: 30'-0"
Depth: 51'-0"
Height: 22'-0"
Foundation: Crawl Space



MALDEN RIDGE - PLAN M1852B2F-0

MAIN FLOOR

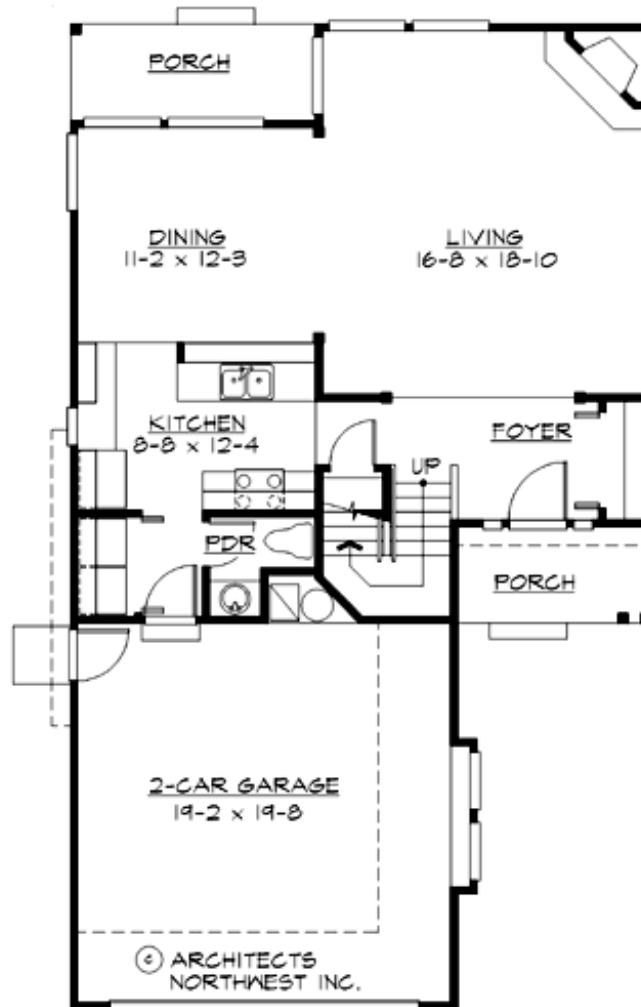

MALDEN RIDGE - PLAN M1852B2F-0

UPPER FLOOR

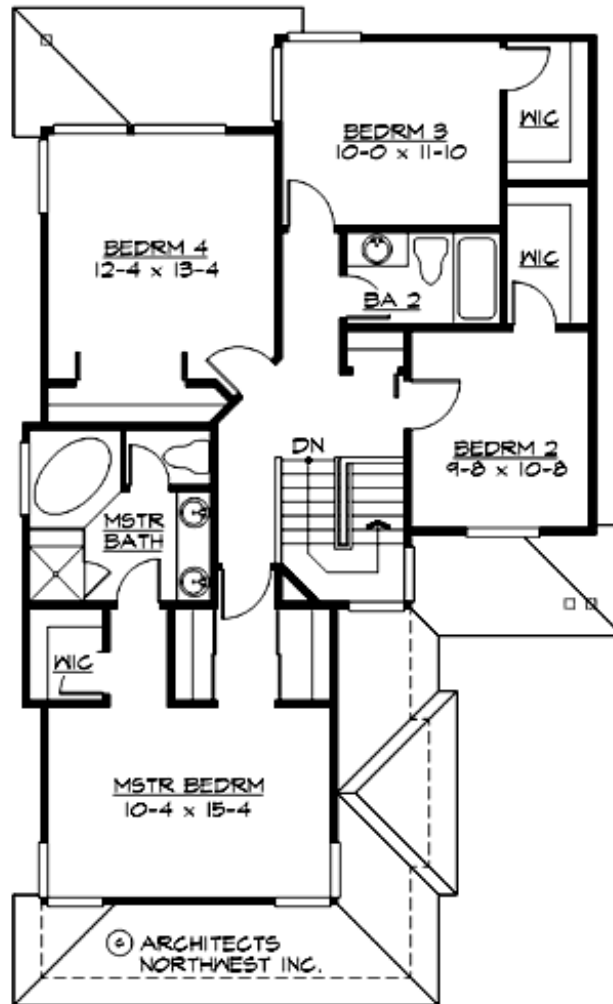



MALDEN RIDGE - PLAN M1852B2F-0

PLAN DETAILS

Area Summary

Total Area: 1852 sq. ft.
Main Floor: 807 sq. ft.
Upper Floor: 1045 sq. ft.
Garage Floor: 418 sq. ft.

General Information

Stories: 2
Width: 30'-0"
Depth: 51'-0"
Height: 22'-0"

Architectural Style

Craftsman
Farmhouse
Northwest

Number of Rooms

Bedrooms: 4
Full Baths: 2
Half Baths: 1

Garage

Garage Size: 2
Garage Door Location: Front

Roof Pitches

Primary: 5:12

Wall Heights

Main: 8'-0"
Upper: 8'-0"
3rd Floor: 0'-0"
Lower: 0'-0"

Foundation Type

Crawl Space

Roof Framing

Trusses

Floor Load

Live (lbs): 40 PSF
Dead (lbs): 10 PSF

Roof Load

Live (lbs): 25 PSF
Dead (lbs): 15 PSF
Wind: 85 MPH

Design Features

- Front and Rear Porch
- Great Room
- Laundry Room @ Main Floor
- Master Bedroom @ Upper Floor Front
- Narrow Lot
- Small Plan