

GLACIER PEAK - PLAN M1450A0-0

Total Area: 1450 sq. ft.
Garage Area: 0 sq. ft.
Garage Area: 0 sq. ft.
Garage Size: No Garage
Stories: 2
Bedrooms: 3
Full Baths: 2
Width: 32'-0"
Depth: 37'-0"
Height: 23'-6"
Foundation: Crawl Space



GLACIER PEAK - PLAN M1450A0-0

MAIN FLOOR

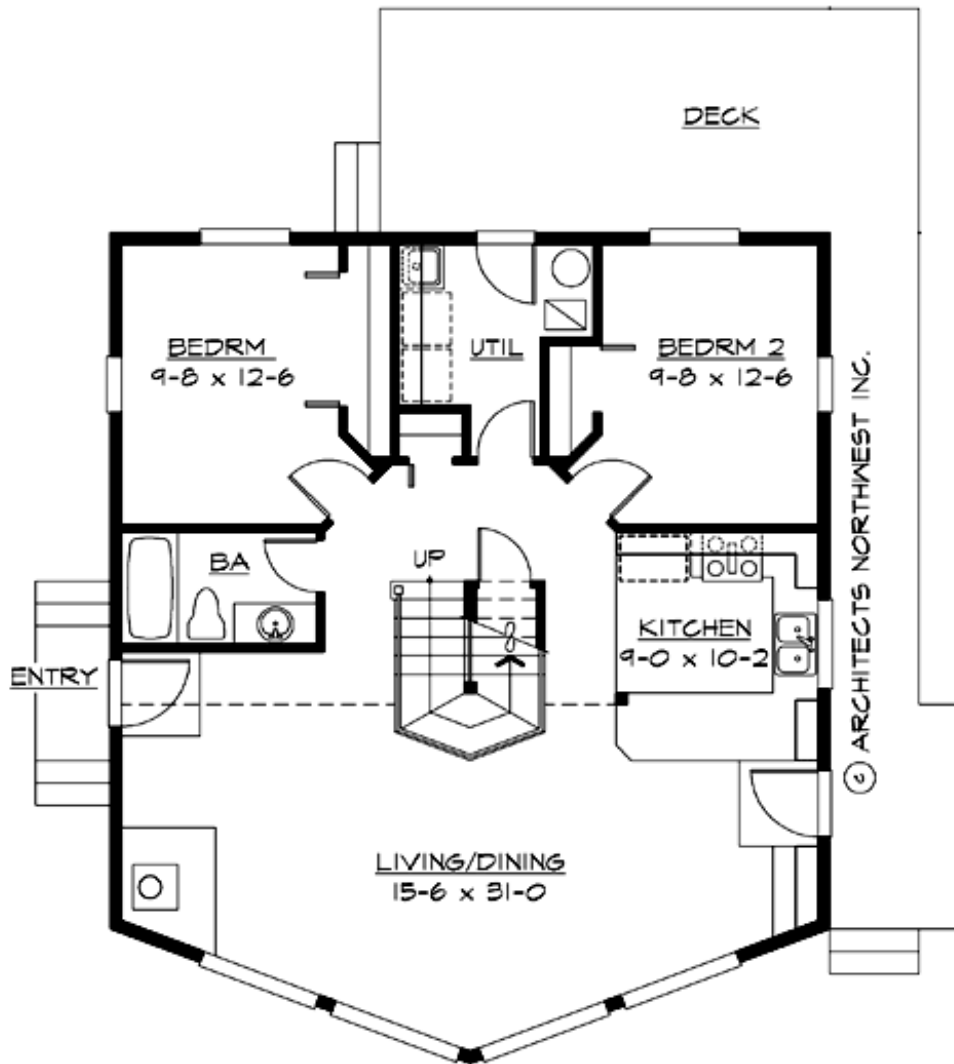

GLACIER PEAK - PLAN M1450A0-0

UPPER FLOOR

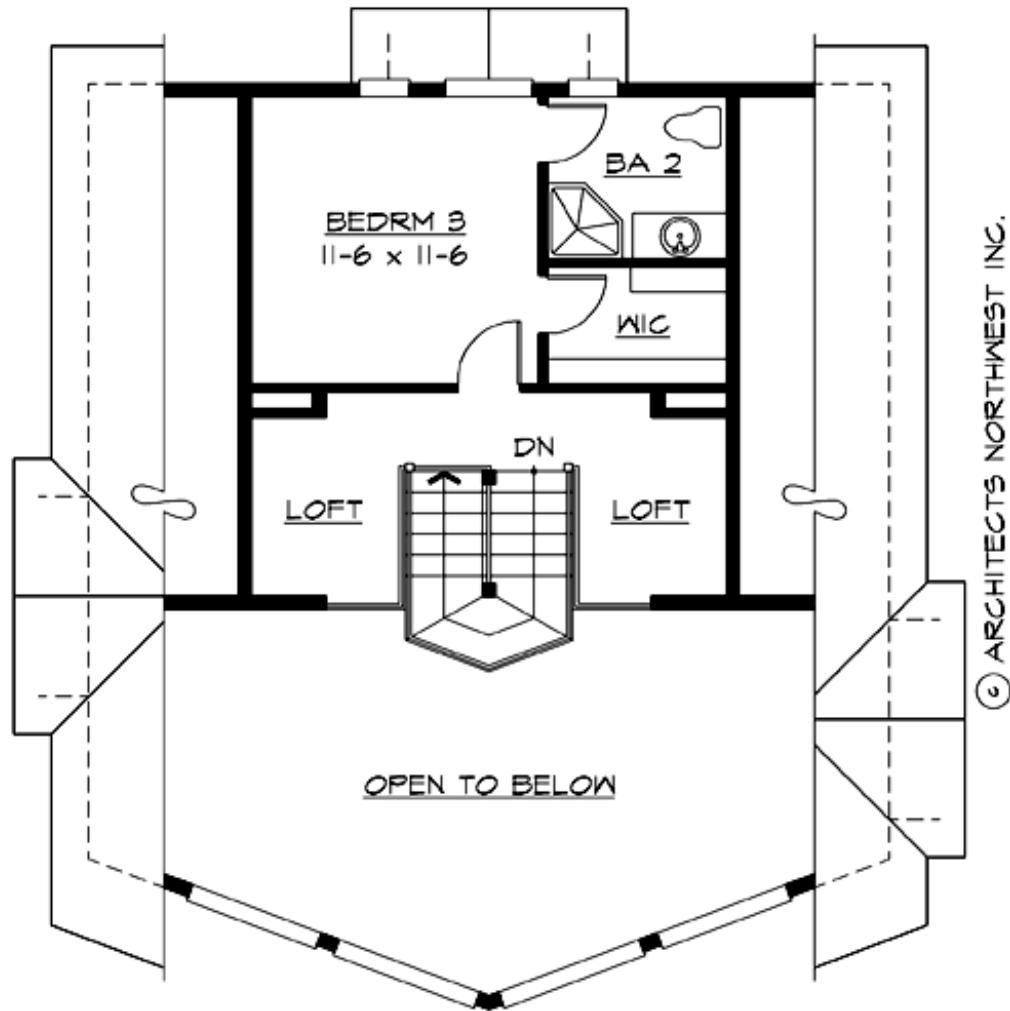

GLACIER PEAK - PLAN M1450A0-0

PLAN DETAILS

Area Summary

Total Area: 1450 sq. ft.
Main Floor: 1088 sq. ft.
Upper Floor: 362 sq. ft.

General Information

Stories: 2
Width: 32'-0"
Depth: 37'-0"
Height: 23'-6"

Architectural Style

Alpine
Cottage
Mountain

Number of Rooms

Bedrooms: 3
Full Baths: 2

Garage

No Garage

Roof Pitches

Primary: 9:12

Wall Heights

Main: 8'-0"
Upper: 8'-0"
3rd Floor: 0'-0"
Lower: 0'-0"

Foundation Type

Crawl Space

Roof Framing

Stick

Floor Load

Live (lbs): 40 PSF
Dead (lbs): 10 PSF

Roof Load

Live (lbs): 25 PSF
Dead (lbs): 15 PSF
Wind: 85 MPH

Design Features

- Laundry Room @ Main Floor
- Living & Family Room
- Master Bedroom @ Upper Floor Rear
- Narrow Lot
- Vacation Plan