

## **ASTORIA - M4725A4S-1**

Total Area: **5250 Sq. Ft.**  
Garage Area: **1090 Sq. Ft.**  
Garage Size: **4**  
Stories: **2**  
Bedrooms : **4**  
Full Baths : **4**  
Half Baths : **1**  
Width : **71`-0"**  
Depth : **92`-0"**  
Height : **40`-6"**  
Foundation : **Crawl Space**



# ASTORIA - M4725A4S-1

## MAIN FLOOR

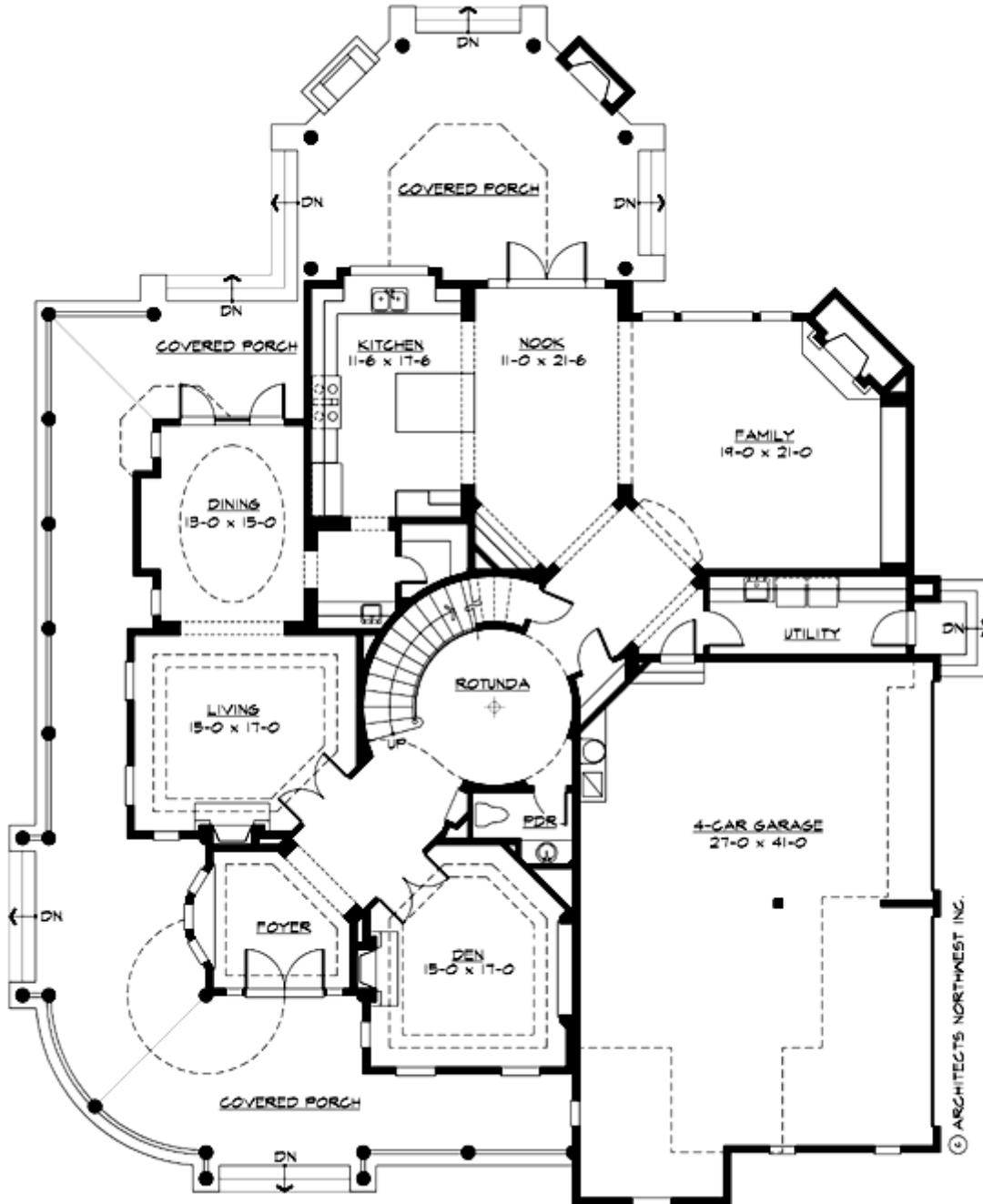



# ASTORIA - M4725A4S-1

## PLAN DETAILS

### Area Summary

Total Area:	<b>5250 Sq. Ft.</b>
Main Floor:	<b>2375 Sq. Ft.</b>
Upper Floor:	<b>2875 Sq. Ft.</b>
Garage Floor:	<b>1090 Sq. Ft.</b>

### General Information

Stories:	<b>2</b>
Width:	<b>71`-0"</b>
Depth:	<b>92`-0"</b>
Height:	<b>40`-6"</b>

### Architectural Style

Farmhouse  
Shingle  
Victorian

### Number of Rooms

Bedrooms:	<b>4</b>
Full Baths:	<b>4</b>
Half Baths:	<b>1</b>

### Garage

Garage Size:	<b>4</b>
Garage Door Location:	<b>Side</b>

### Roof Pitches

Primary:	<b>10:12</b>
Secondary:	<b>4:12</b>

### Wall Heights

Main:	<b>9-0"</b>
Upper:	<b>9-0"</b>

### Foundation Type

Crawl Space

### Roof Framing

Combination

### Floor Load

Live (lbs):	<b>40 PSF</b>
Dead (lbs):	<b>10 PSF</b>

### Roof Load

Live (lbs):	<b>25 PSF</b>
Dead (lbs):	<b>15 PSF</b>
Wind:	<b>85 MPH</b>

### Design Features

- Award Winning Designs
- Best Selling Plans
- Bonus Space @ & Upper Floor
- Den/Office
- Wrap-Around Porch
- Great Room
- Master Bedroom @ Upper Floor Rear
- Farmhouse Home Plans
- Shingle House Plans
- Victorian House Designs
- Luxury Home Designs