

**ARCHITECTS  
NORTHWEST**

Your Family Architect



For Questions and Ordering

**Call: 1-888-272-4100**

E-mail: [Info@ArchitectsNW.com](mailto:Info@ArchitectsNW.com)

## **FORTUNE CREEK LODGE - M7800A3FA-0**

Total Area: **8450 Sq. Ft.**  
Garage Area: **1575 Sq. Ft.**  
Garage Size: **3**  
Stories: **2**  
Bedrooms : **6**  
Full Baths : **5**  
Half Baths : **2**  
Width : **154`-0"**  
Depth : **112`-0"**  
Height : **33`-0"**  
Foundation : **Crawl Space**



# FORTUNE CREEK LODGE - M7800A3FA-0

## MAIN FLOOR

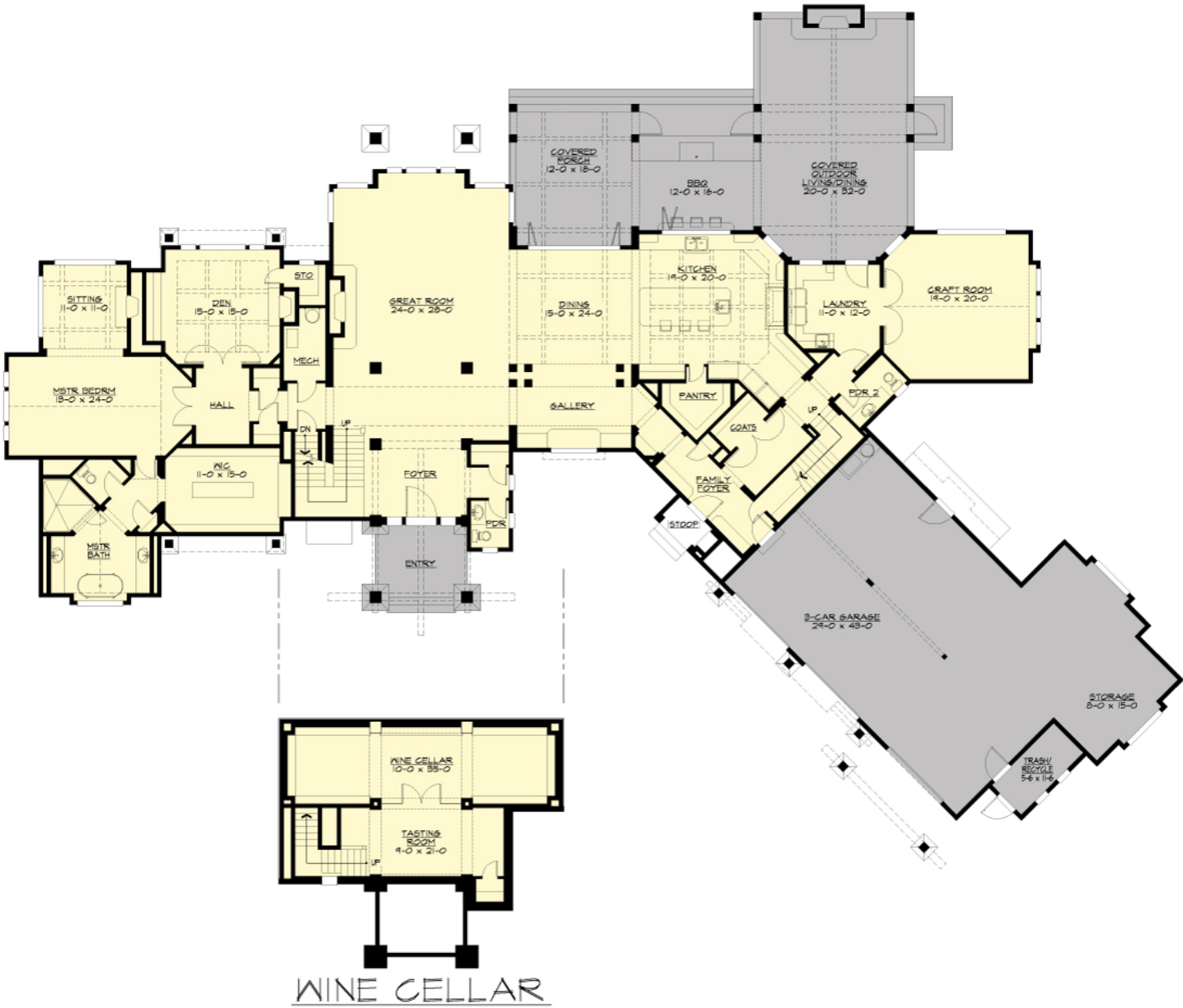

# FORTUNE CREEK LODGE - M7800A3FA-0

## UPPER FLOOR



# FORTUNE CREEK LODGE - M7800A3FA-0

## PLAN DETAILS

### Area Summary

Total Area:	<b>8450 Sq. Ft.</b>
Main Floor:	<b>4468 Sq. Ft.</b>
Upper Floor:	<b>3332 Sq. Ft.</b>
Lower Floor:	<b>650 Sq. Ft.</b>
Garage Floor:	<b>1575 Sq. Ft.</b>

### General Information

Stories:	<b>2</b>
Width:	<b>154`-0"</b>
Depth:	<b>112`-0"</b>
Height:	<b>33`-0"</b>

### Architectural Style

Craftsman  
Lodge  
Mountain

### Number of Rooms

Bedrooms:	<b>6</b>
Full Baths:	<b>5</b>
Half Baths:	<b>2</b>

### Garage

Garage Size:	<b>3</b>
Garage Door Location:	<b>Front</b>
Garage Type:	<b>Angled</b>

### Roof Pitches

Primary:	<b>8:12</b>
Secondary:	<b>4:12</b>

### Wall Heights

Main:	<b>10-0"</b>
Upper:	<b>9-0"</b>
Lower:	<b>9-0"</b>

### Foundation Type

Crawl Space

### Roof Framing

Combination

### Floor Load

Live (lbs):	<b>40 PSF</b>
Dead (lbs):	<b>10 PSF</b>

### Roof Load

Live (lbs):	<b>131 PSF</b>
Dead (lbs):	<b>15 PSF</b>
Wind:	<b>85 MPH</b>

### Design Features

- Suncadia Collection
- Bonus Space @ & Upper Floor
- Den/Office
- Rear Porch
- Great Room
- Laundry Room @ Main Floor
- Master Bedroom @ Main Floor Rear
- Craftsman House Plans
- Lodge House Plans
- Mountain House Plans
- Luxury Home Designs
- Wide Lot House Plans