

GLACIER PEAK - M1450A0-0

Total Area: **1450 Sq. Ft.**
Garage Area: **0 Sq. Ft.**
Garage Size: **No Garage**
Stories: **2**
Bedrooms : **3**
Full Baths : **2**
Half Baths :
Width : **32`-0"**
Depth : **37`-0"**
Height : **23`-6"**
Foundation : **Crawl Space**



GLACIER PEAK - M1450A0-0

MAIN FLOOR

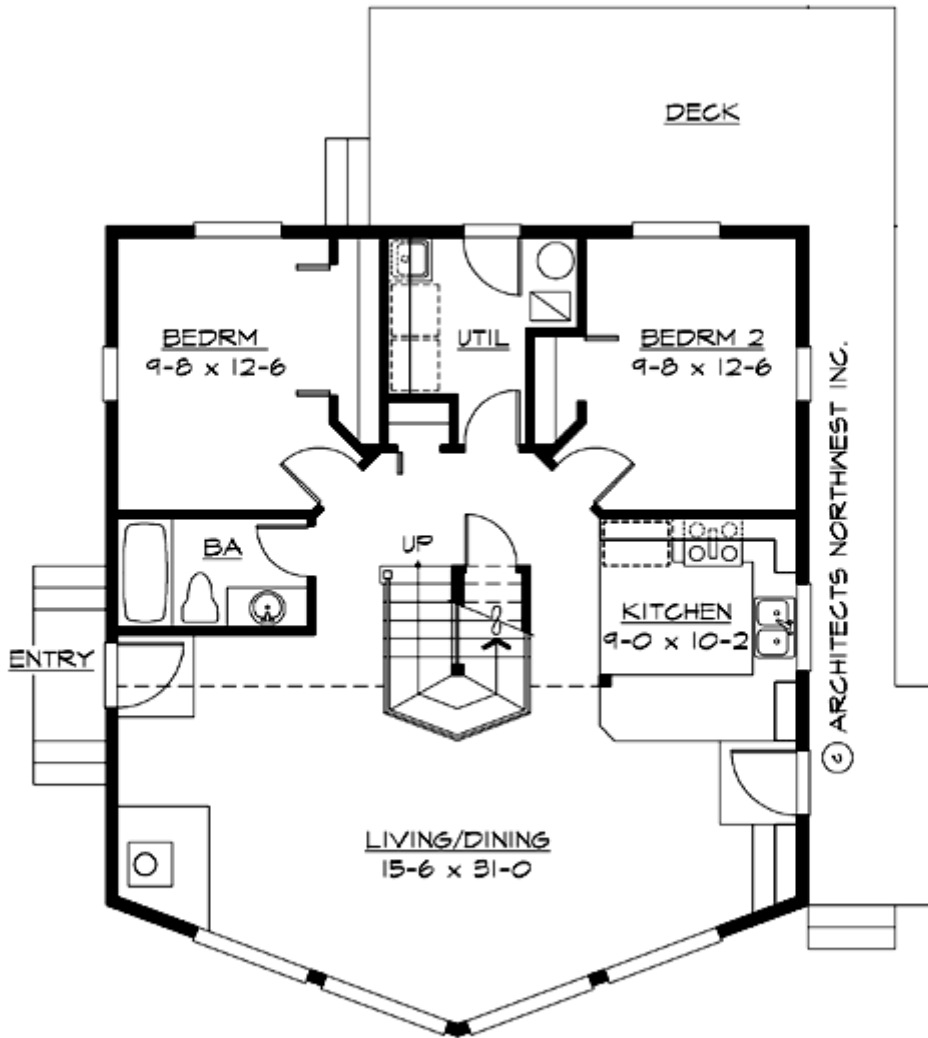

GLACIER PEAK - M1450A0-0

UPPER FLOOR

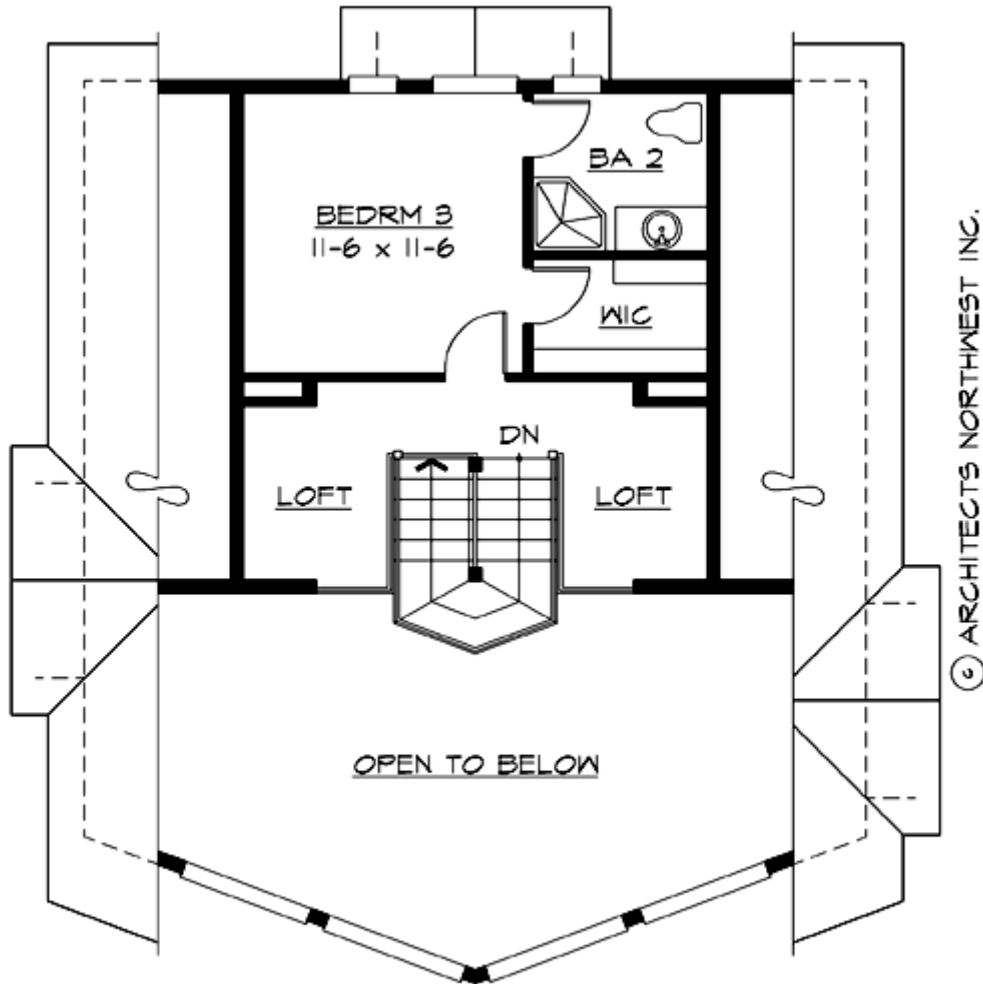

© ARCHITECTS NORTHWEST INC.

GLACIER PEAK - M1450A0-0

PLAN DETAILS

Area Summary

Total Area:	1450 Sq. Ft.
Main Floor:	1088 Sq. Ft.
Upper Floor:	362 Sq. Ft.

General Information

Stories:	2
Width:	32`-0"
Depth:	37`-0"
Height:	23`-6"

Architectural Style

Alpine
Cottage
Mountain

Number of Rooms

Bedrooms:	3
Full Baths:	2

Garage

Garage Size: **No Garage**

Roof Pitches

Primary: **9:12**

Wall Heights

Main:	8-0"
Upper:	8-0"

Foundation Type

Crawl Space

Roof Framing

Stick

Floor Load

Live (lbs):	40 PSF
Dead (lbs):	10 PSF

Roof Load

Live (lbs):	25 PSF
Dead (lbs):	15 PSF
Wind:	85 MPH

Design Features

- Great Room
- Laundry Room @ Main Floor
- Master Bedroom @ Upper Floor Rear
- Alpine House Designs
- Cottage House Plans
- Mountain House Plans
- Narrow Lot House Plans
- Vacation House Plans