

LITTLE ROCK - A745A2SU-0

Total Area: **745 Sq. Ft.**
Garage Area: **768 Sq. Ft.**
Garage Size: **2**
Stories: **2**
Bedrooms : **2**
Full Baths : **1**
Half Baths :
Width : **32`-0"**
Depth : **28`-0"**
Height : **14`-6"**
Foundation : **Slab**



LITTLE ROCK - A745A2SU-0

MAIN FLOOR



LITTLE ROCK - A745A2SU-0

LOWER FLOOR

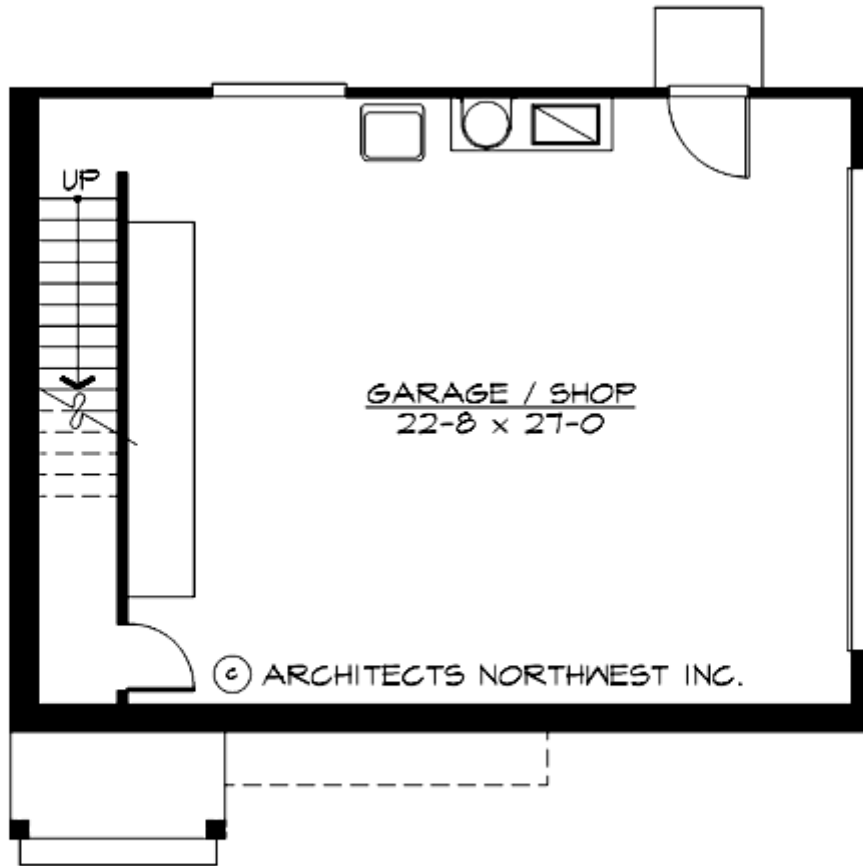

LITTLE ROCK - A745A2SU-0

PLAN DETAILS

Area Summary

Total Area: **745 Sq. Ft.**
Main Floor: **745 Sq. Ft.**
Garage Floor: **768 Sq. Ft.**

General Information

Stories: **2**
Width: **32`-0"**
Depth: **28`-0"**
Height: **14`-6"**

Architectural Style

Carriage
Cottage
Craftsman

Number of Rooms

Bedrooms: **2**
Full Baths: **1**

Garage

Garage Size: **2**
Garage Door Location: **Side**
Garage Type: **Under**

Roof Pitches

Primary: **6:12**

Wall Heights

Main: **8-0"**
Lower: **9-0"**

Foundation Type

Slab On Grade

Roof Framing

Trusses

Floor Load

Live (lbs): **40 PSF**
Dead (lbs): **10 PSF**

Roof Load

Live (lbs): **25 PSF**
Dead (lbs): **15 PSF**
Wind: **85 MPH**

Design Features

- Great Room
- Carriage House Plans
- Cottage House Plans
- Craftsman House Plans
- Narrow Lot House Plans