

TREASURE BARN - A1955A5FT-0

Total Area: **1955 Sq. Ft.**
Garage Area: **2065 Sq. Ft.**
Garage Size: **5+**
Stories: **2**
Bedrooms : **1**
Full Baths : **2**
Half Baths :
Width : **81`-0"**
Depth : **47`-6"**
Height : **30`-0"**
Foundation : **Slab**



TREASURE BARN - A1955A5FT-0

MAIN FLOOR



TREASURE BARN - A1955A5FT-0

UPPER FLOOR

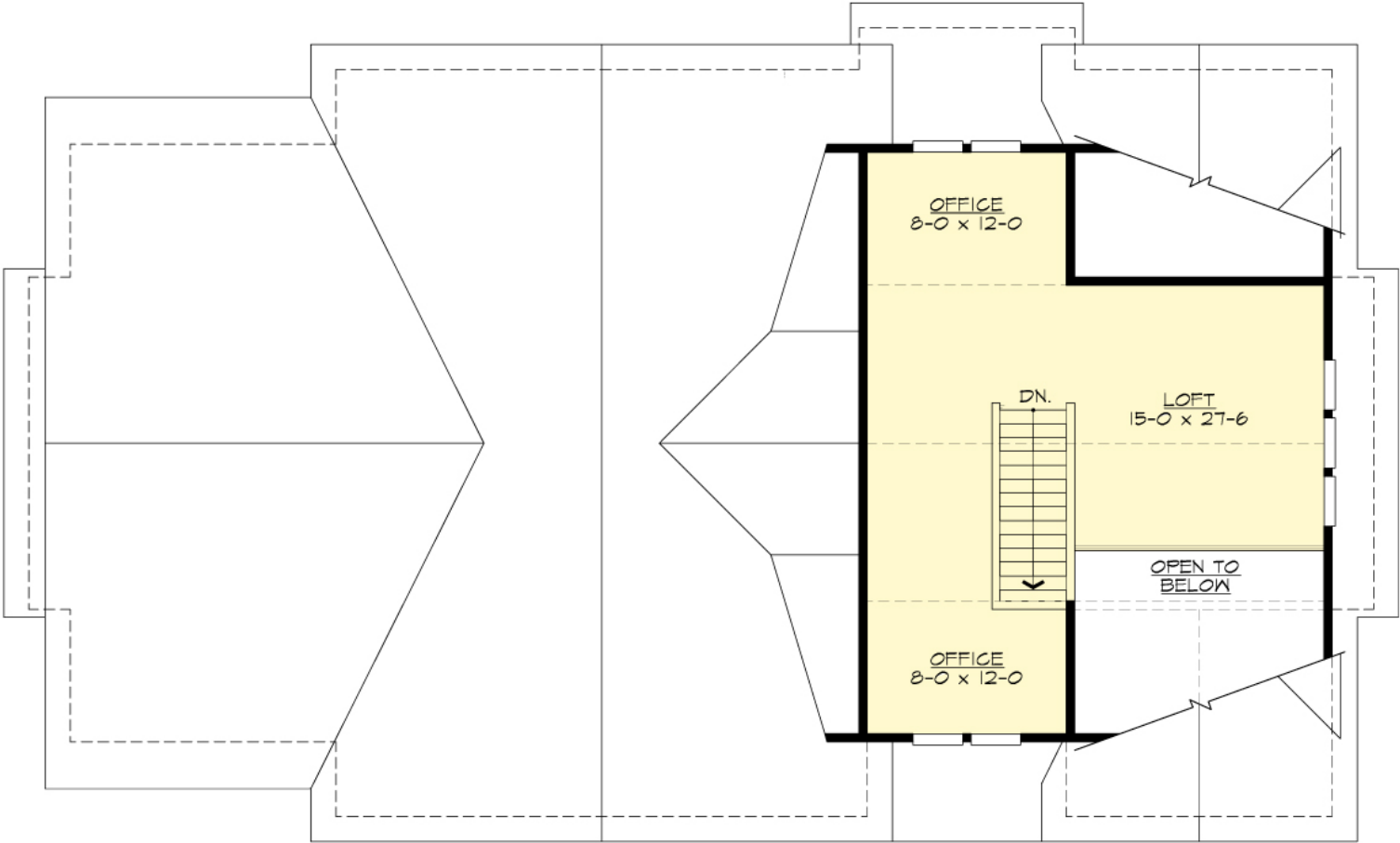

TREASURE BARN - A1955A5FT-0

PLAN DETAILS

Area Summary

Total Area:	1955 Sq. Ft.
Main Floor:	1280 Sq. Ft.
Upper Floor:	675 Sq. Ft.
Garage Floor:	2065 Sq. Ft.

General Information

Stories:	2
Width:	81`-0"
Depth:	47`-6"
Height:	30`-0"

Architectural Style

Country
Farmhouse
Modern

Number of Rooms

Bedrooms:	1
Full Baths:	2

Garage

Garage Size:	5+
Garage Door Location:	Front
Garage Type:	Tandem

Roof Pitches

Primary:	10:12
Secondary:	5:12

Wall Heights

Main:	9-0"
Upper:	8-0"

Foundation Type

Slab On Grade

Roof Framing

Trusses

Floor Load

Live (lbs):	40 PSF
Dead (lbs):	10 PSF

Roof Load

Live (lbs):	25 PSF
Dead (lbs):	15 PSF
Wind:	85 MPH

Design Features

- Bonus Space @ & Upper Floor
- Great Room
- Laundry Room @ Main Floor
- Master Bedroom @ Main Floor Rear
- Country House Plans
- Farmhouse Home Plans
- Modern Home Plans
- Small House Plans
- Wide Lot House Plans