

MACLAREN PARK - PLAN M4446A3S-0

Total Area: 4446 sq. ft.
Garage Area: 828 sq. ft.
Garage Area: 828 sq. ft.
Garage Size: 3
Stories: 2
Bedrooms: 4
Full Baths: 3
Half Baths: 1
Width: 53'-0"
Depth: 85'-0"
Height: 25'-0"
Foundation: Crawl Space



MACLAREN PARK - PLAN M4446A3S-0

MAIN FLOOR



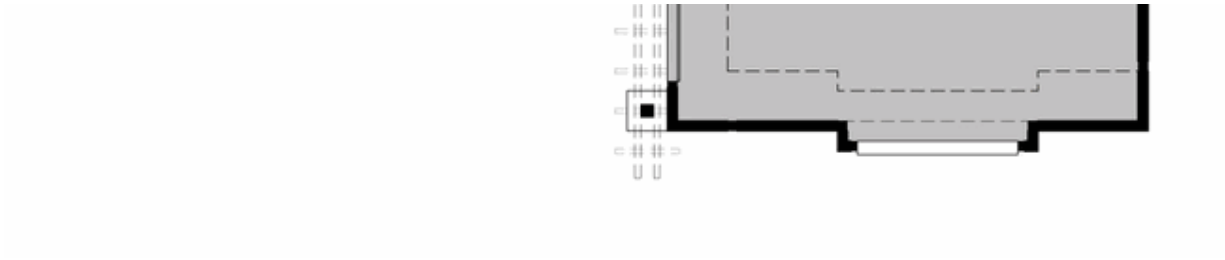

MACLAREN PARK - PLAN M4446A3S-0

UPPER FLOOR



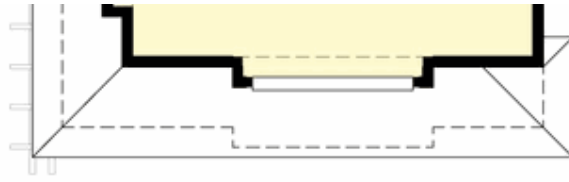

MACLAREN PARK - PLAN M4446A3S-0

PLAN DETAILS

Area Summary

Total Area: 4446 sq. ft.
Main Floor: 2109 sq. ft.
Upper Floor: 2337 sq. ft.
Garage Floor: 828 sq. ft.

General Information

Stories: 2
Width: 53'-0"
Depth: 85'-0"
Height: 25'-0"

Architectural Style

Craftsman
Northwest
Shingle

Number of Rooms

Bedrooms: 4
Full Baths: 3
Half Baths: 1

Garage

Garage Size: 3
Garage Door Location: Side

Roof Pitches

Primary: 6:12
Secondary: 4:12

Wall Heights

Main: 10'-0"
Upper: 9'-0"

Foundation Type

Crawl Space

Roof Framing

Trusses

Floor Load

Live (lbs): 40 PSF
Dead (lbs): 10 PSF

Roof Load

Live (lbs): 25 PSF
Dead (lbs): 15 PSF
Wind: 85 MPH

Design Features

- Bonus Space @ Upper Floor
- Den/Office
- Front and Rear Porch
- Great Room
- Laundry Room @ Upper Floor
- Master Bedroom @ Upper Floor Front
- Narrow Lot