

TREASURE BARN - PLAN A1955A5FT-0

Total Area: 1955 sq. ft.
Garage Area: 2065 sq. ft.
Garage Area: 2065 sq. ft.
Garage Size: 5+
Stories: 2
Bedrooms: 1
Full Baths: 2
Width: 81'-0"
Depth: 47'-6"
Height: 30'-0"
Foundation: Slab On Grade



TREASURE BARN - PLAN A1955A5FT-0

MAIN FLOOR



TREASURE BARN - PLAN A1955A5FT-0

UPPER FLOOR

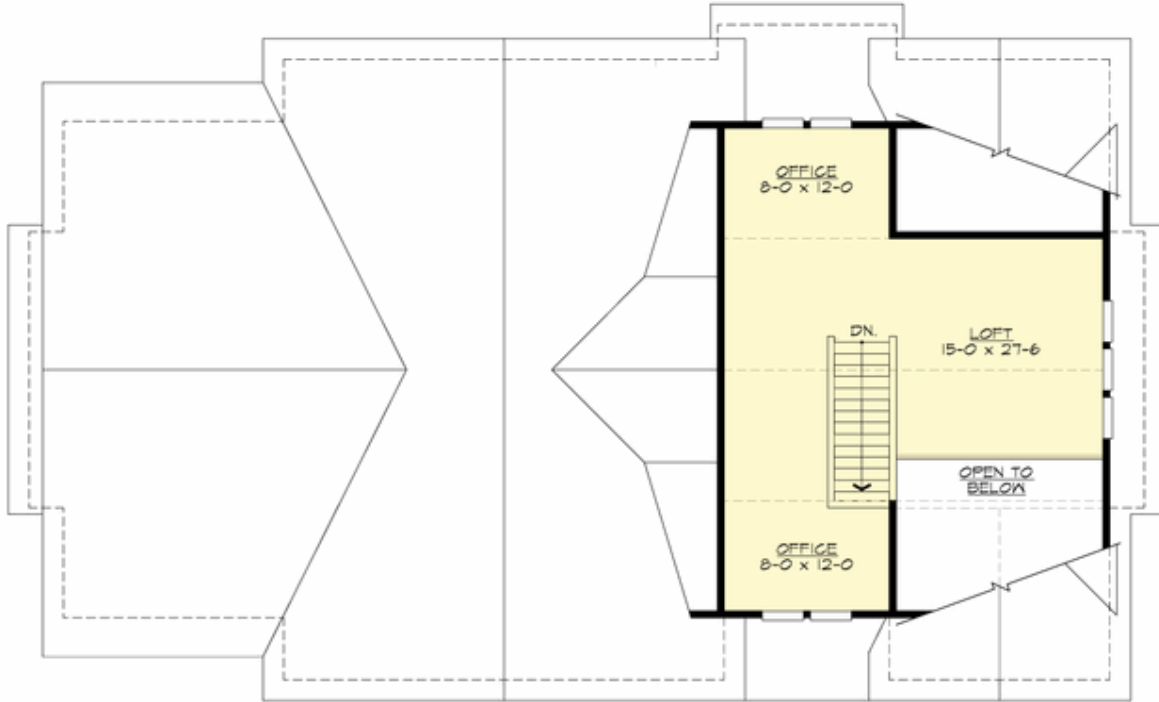



TREASURE BARN - PLAN A1955A5FT-0

PLAN DETAILS

Area Summary

Total Area: 1955 sq. ft.
Main Floor: 1280 sq. ft.
Upper Floor: 675 sq. ft.
Garage Floor: 2065 sq. ft.

General Information

Stories: 2
Width: 81'-0"
Depth: 47'-6"
Height: 30'-0"

Architectural Style

Country
Farmhouse
Modern

Number of Rooms

Bedrooms: 1
Full Baths: 2

Garage

Garage Size: 5+
Garage Door Location: Front
Garage Type: Tandem

Roof Pitches

Primary: 10:12
Secondary: 5:12

Wall Heights

Main: 9'-0"
Upper: 8'-0"

Foundation Type

Slab On Grade

Roof Framing

Trusses

Floor Load

Live (lbs): 40 PSF
Dead (lbs): 10 PSF

Roof Load

Live (lbs): 25 PSF
Dead (lbs): 15 PSF
Wind: 85 MPH

Design Features

- Bonus Space @ Upper Floor
- Great Room
- Laundry Room @ Main Floor
- Master Bedroom @ Main Floor Rear
- Small Plan
- Wide Lot