

AVONDALE PARK - PLAN M3105A3S-0

Total Area: 3105 sq. ft.
Garage Area: 735 sq. ft.
Garage Area: 735 sq. ft.
Garage Size: 3
Stories: 2
Bedrooms: 3
Full Baths: 2
Half Baths: 1
Width: 50'-0"
Depth: 76'-0"
Height: 26'-6"
Foundation: Crawl Space



AVONDALE PARK - PLAN M3105A3S-0

MAIN FLOOR

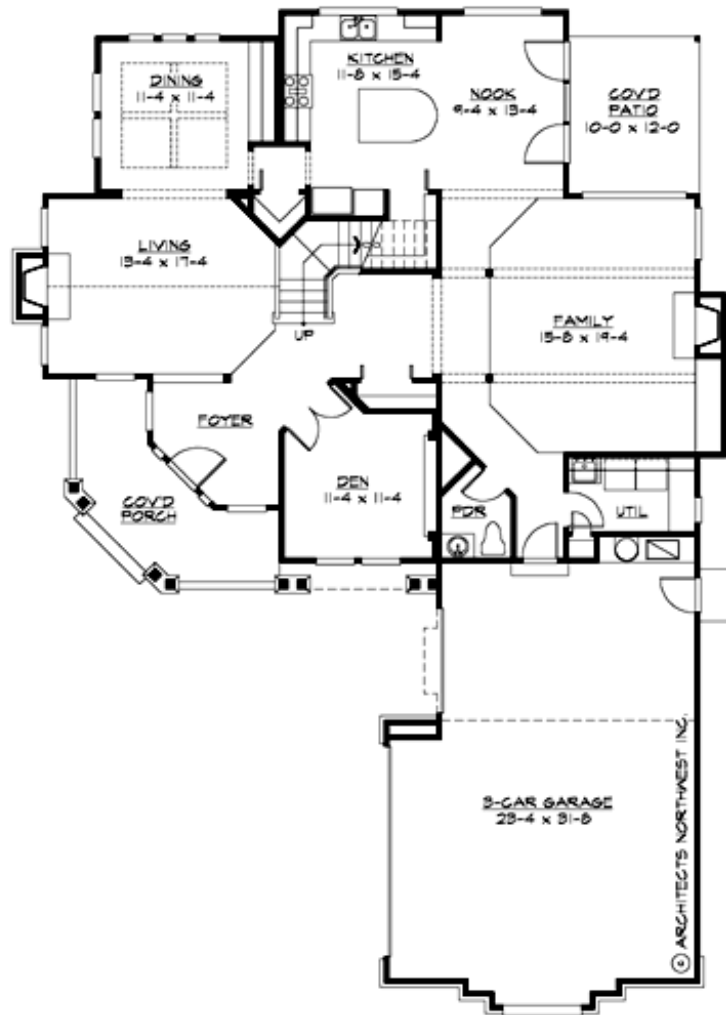

AVONDALE PARK - PLAN M3105A3S-0

UPPER FLOOR

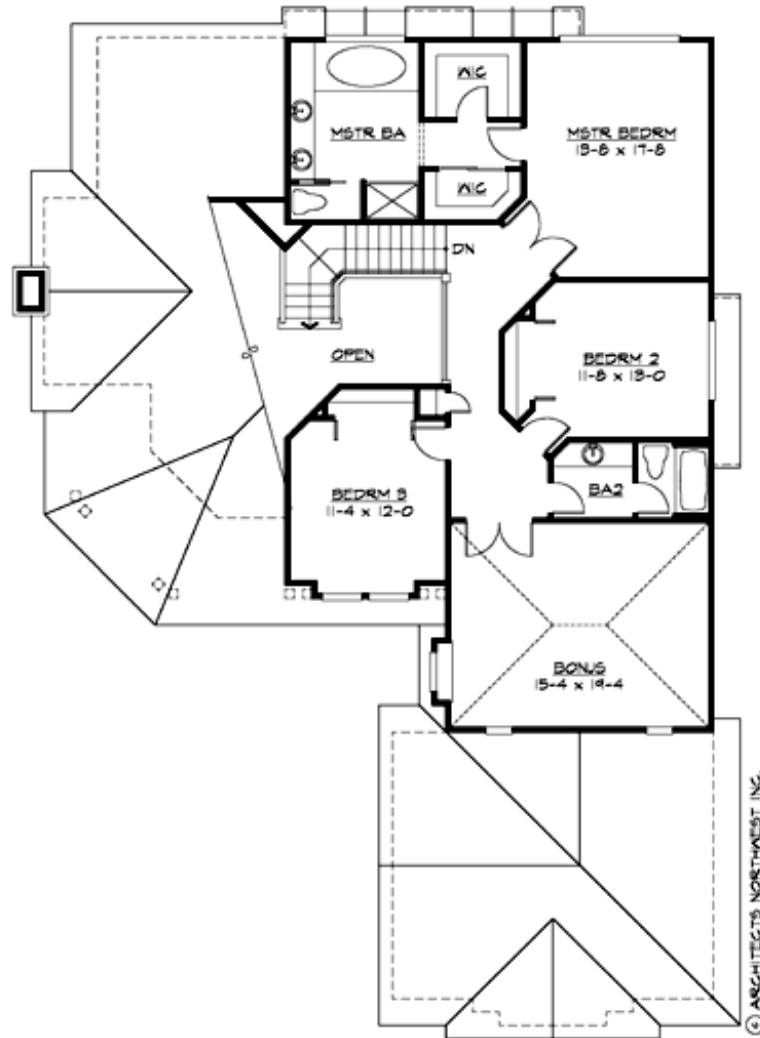



AVONDALE PARK - PLAN M3105A3S-0

PLAN DETAILS

Area Summary

Total Area: 3105 sq. ft.
Main Floor: 1709 sq. ft.
Upper Floor: 1396 sq. ft.
Garage Floor: 735 sq. ft.

General Information

Stories: 2
Width: 50'-0"
Depth: 76'-0"
Height: 26'-6"

Architectural Style

Craftsman
Farmhouse
Northwest

Number of Rooms

Bedrooms: 3
Full Baths: 2
Half Baths: 1

Garage

Garage Size: 3
Garage Door Location: Side

Roof Pitches

Primary: 6:12

Wall Heights

Main: 9'-0"
Upper: 8'-0"
3rd Floor: 0'-0"
Lower: 0'-0"

Foundation Type

Crawl Space

Roof Framing

Trusses

Floor Load

Live (lbs): 40 PSF
Dead (lbs): 10 PSF

Roof Load

Live (lbs): 25 PSF
Dead (lbs): 15 PSF
Wind: 85 MPH

Design Features

- Bonus Space @ Upper Floor
- Den/Office
- Front Porch
- Laundry Room @ Main Floor
- Living & Family Room
- Master Bedroom @ Upper Floor Rear
- Narrow Lot