

CHESAPEAKE LANE - PLAN M5091A3S-0DB

Total Area: 5091 sq. ft.
Garage Area: 802 sq. ft.
Garage Area: 802 sq. ft.
Garage Size: 3
Stories: 3
Bedrooms: 4
Full Baths: 4
Half Baths: 1
Width: 88'-0"
Depth: 81'-0"
Height: 25'-0"
Foundation: Daylight Basement



CHESAPEAKE LANE - PLAN M5091A3S-0DB

MAIN FLOOR

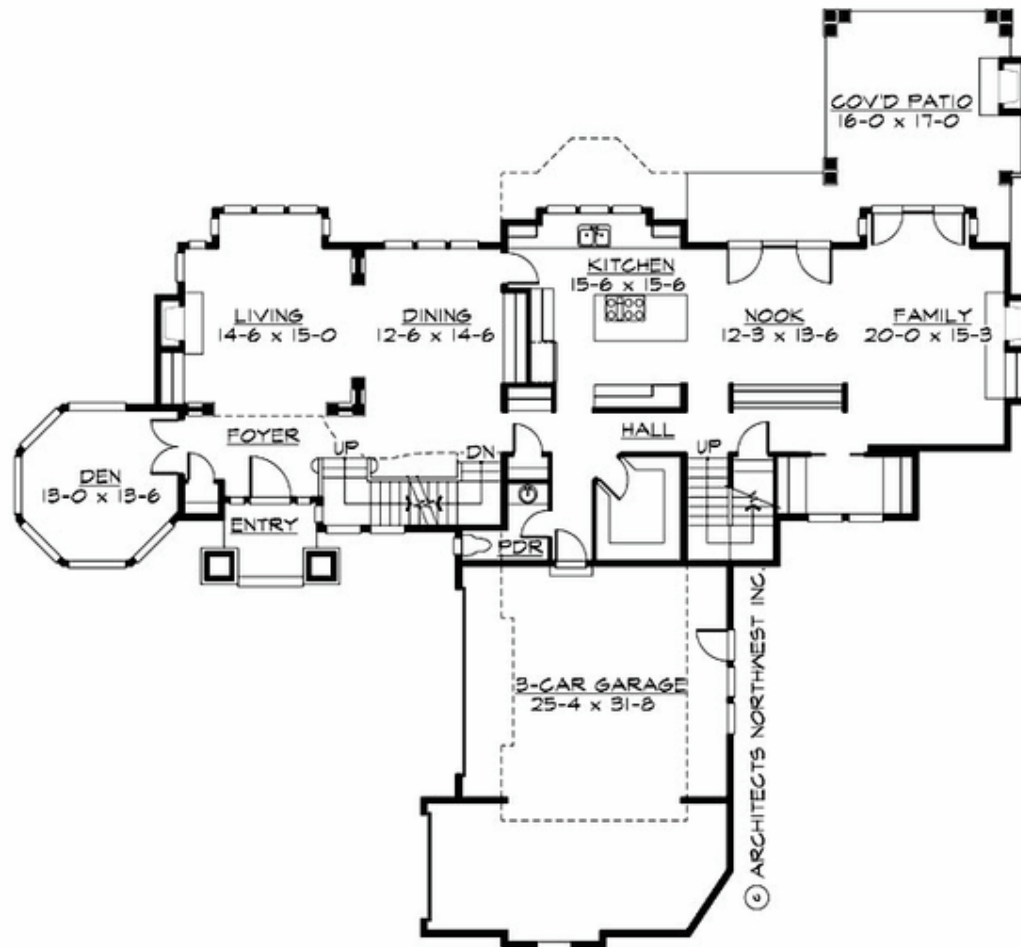

CHESAPEAKE LANE - PLAN M5091A3S-0DB

UPPER FLOOR

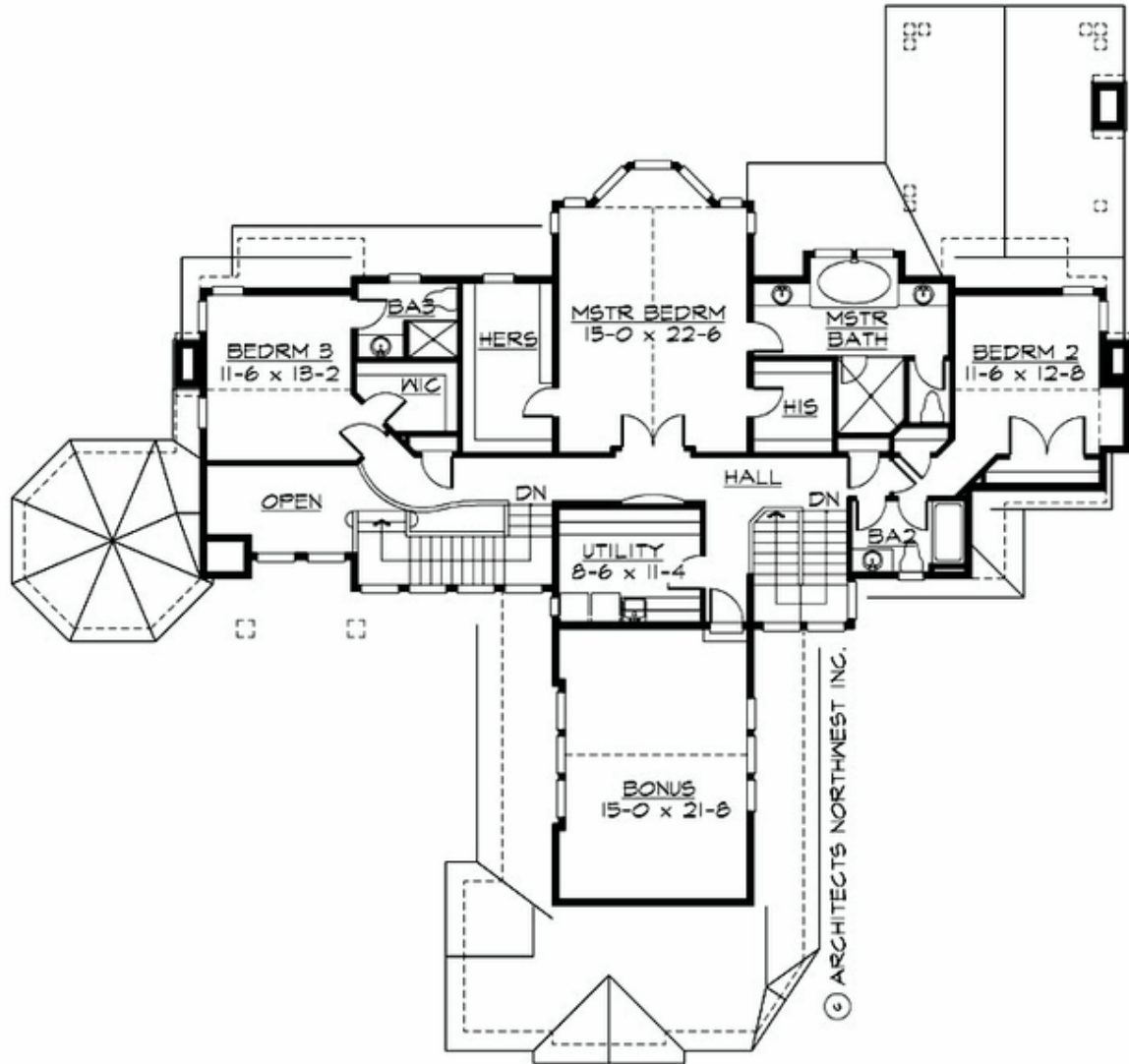

CHESAPEAKE LANE - PLAN M5091A3S-0DB

LOWER FLOOR

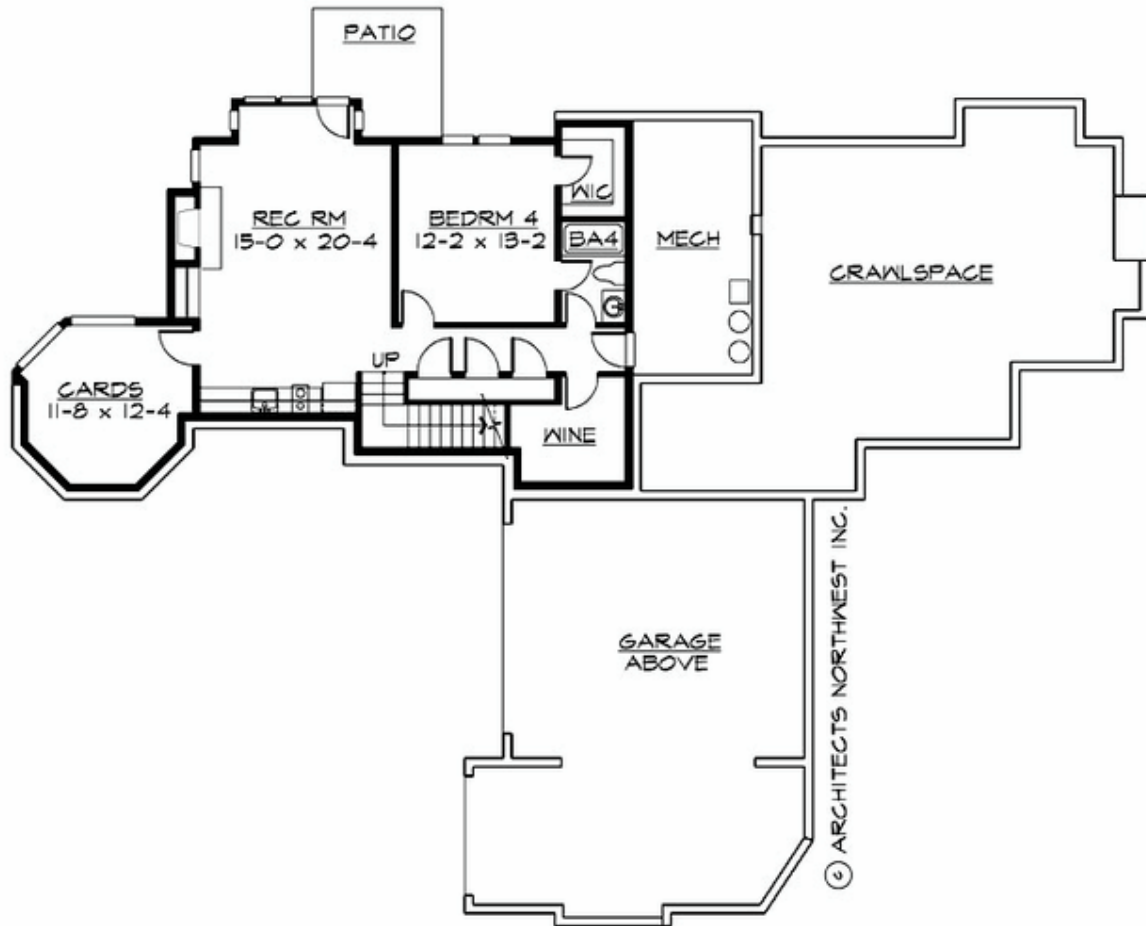

CHESAPEAKE LANE - PLAN M5091A3S-0DB

PLAN DETAILS

Area Summary

Total Area:	5091 sq. ft.
Main Floor:	2084 sq. ft.
Upper Floor:	1935 sq. ft.
Lower Floor:	1072 sq. ft.
Garage Floor:	802 sq. ft.

General Information

Stories:	3
Width:	88'-0"
Depth:	81'-0"
Height:	25'-0"

Architectural Style

Craftsman
Hampton
Shingle

Number of Rooms

Bedrooms:	4
Full Baths:	4
Half Baths:	1

Garage

Garage Size:	3
Garage Door Location:	Side

Roof Pitches

Primary:	8:12
----------	------

Wall Heights

Main:	10'-0"
Upper:	8'-0"
3rd Floor:	0'-0"
Lower:	10'-0"

Foundation Type

Daylight Basement

Roof Framing

Combination

Floor Load

Live (lbs):	40 PSF
Dead (lbs):	10 PSF

Roof Load

Live (lbs):	25 PSF
Dead (lbs):	15 PSF
Wind:	85 MPH

Design Features

- Bonus Space @ Upper Floor & Lower Floor
- Den/Office
- Laundry Room @ Upper Floor
- Living & Family Room
- Master Bedroom @ Upper Floor Rear
- Rear Porch